

COMPRESSION LOADCELL

Model CT28

Simple mechanical design
Scrap bucket, roller table weighing scales. Crane scales.
Service temperature up to 120°C.

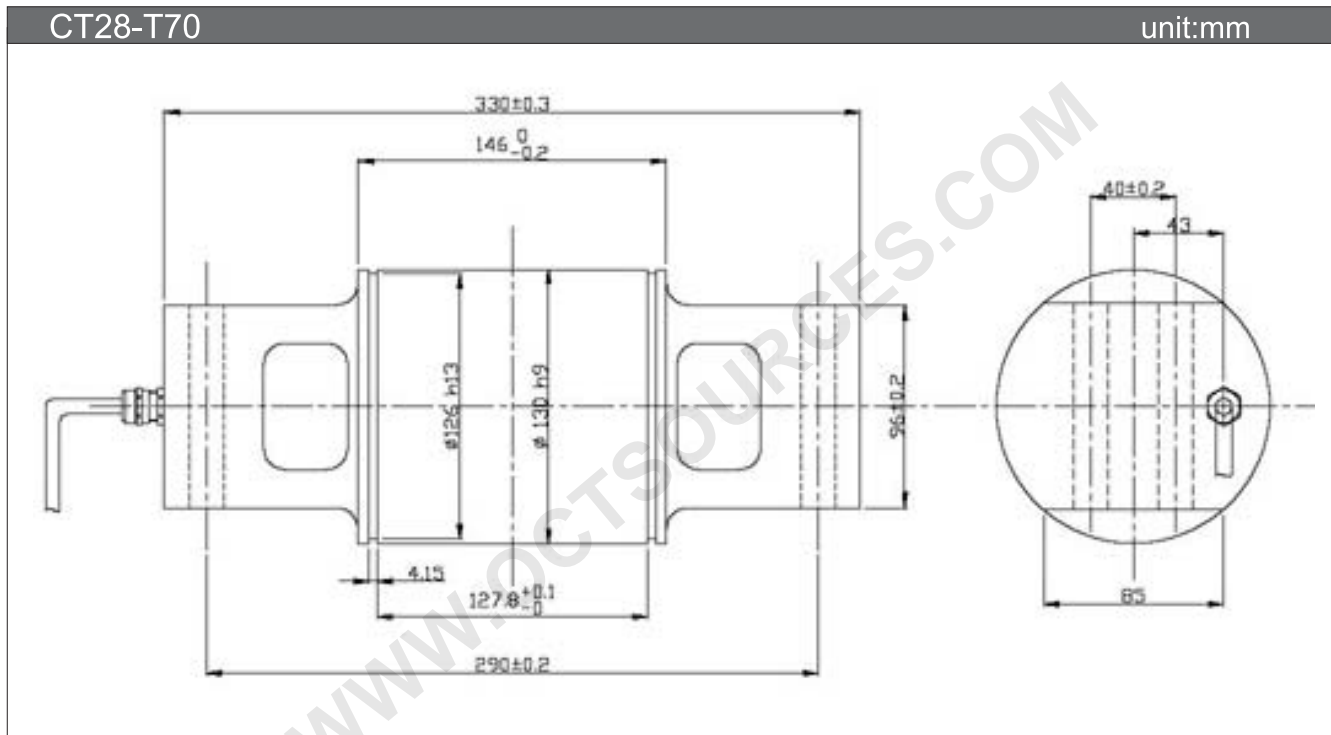

SPECIFICATIONS

Specification	Accuracy
Model	CT28
Rated Capacity(R.O.)	70tf
Rated Output(R.O.)	1.10mV/V
Limit load = Max. admissible load	140t
Combined error	± 0.5%
Creeping under load(30 m)	±0.05%
Resistance, Input	380 ohm ±3 ohm
Resistance, Output	350 ohm ±2 ohm
Reference supply voltage	10V
Max.supply voltage	15V
Nominal Temp.Range	-10°C to +80°C
Service Temp. Range	-15°C to +120°C
Reference Temp.	+22°C
Storage Temp. Range	-50°C to +130°C
Temp.effect on zero balance	±0.1%/10K
Temp. effect on rated output	±0.07%/10K
Dead weight	27kg
Corrosion protection	metallic bright , stainless
Protection class	IP65
Cable specification	Special silicone RAL7000(grey) Ø7mm x 15M
Colour code	EXC + : Red, EXC-: White, SIG+ :Black, SIG-:Green